

Galvanised Slab Nails

Geometrical Testing				Test Report No.	Certificate No.	Characteristic yield moment $M_{y,k}$ (Nmm) In acc. with BS EN 409:2009	Characteristic withdrawal parameter $f_{ax,k}$ (N/mm ²) In acc. with BS EN 1382:2000		Characteristic head pull-through parameter $f_{head,k}$ (N/mm ²)	Characteristic tensile capacity $f_{tens,k}$ (N/mm ²)	Durability (Corrosion Protection) Service Class Note* 5 lots tested In cc. To EN1995-1-1
Length L (mm)	Diameter d (mm)	Head Area (mm ²)	Point Length (mm)				Loading across the fibre	Loading along the fibre			
100	3.35	346.10	5.04	30-10775/5	E-30-20419-16	5 873	3.43	2.27	10.91	3.73	2
125	3.75	349.27	5.09	30-10775/6	E-30-20420-16	7 020	3.60	2.06	10.11	6.89	2
150	3.75	349.27	5.09	30-10775/6	E-30-20420-16	7 020	3.60	2.06	10.11	6.89	2
180	4.50	338.69	7.84	30-10775/7	E-30-20421-16	12 982	3.52	2.44	9.98	9.31	2
200	4.50	338.69	7.84	30-10775/7	E-30-20421-16	12 982	3.52	2.44	9.98	9.31	2

- Characteristic withdrawal parameter: Density of wood used: = 350 kg/m³. Conditioned at 20°C with humidity at 65%.
- Characteristic head pull-through parameter: Density of wood used: = 380 kg/m³.

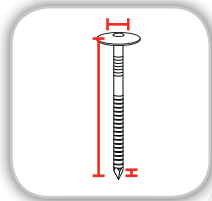

Geometrical

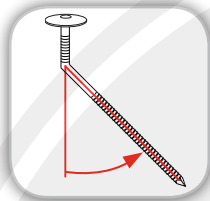

Yield Movement
In acc. with
BS EN 409:2009

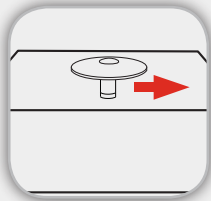

Withdrawal Parameter
In acc. with
BS EN 1382:2000

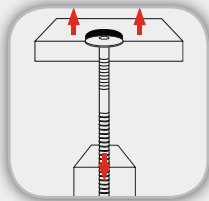

Head Pull-through
In acc. with
BS EN 1383:2000

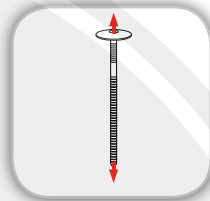

Tensile Ratio
In acc. with
BS EN 1383:2000

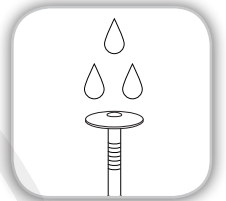

Durability

TIMCO



DECLARATION OF PERFORMANCE

DOP55 v2

We here by declare the following designated products

TIMco Slab Nails Dimensions:

Ø 3.35mm

Ø 3.75mm

Ø 4.50mm

Have been tested by the following independant testing organisation:

- Notified Body 1015
- Strojirensky Zkusebni Ustav, s.p., Czech Republic

And that they have performed initial type testing under system 3, Annex V of the regulation (EU) no. 305/2011 (Construction Products Regulation), with the reference to the harmonised European standard (hEN) BS EN 14592:2008+A1:2012 (Timber structures - Dowel type fasteners - Requirements) for nails intended for the use in "load bearing timber structures" and produced the calculation/test reports and certificates as listed below;

Factory Process Control (FPC) has been established by the factory and independently audited by TUV Rheinland UK in accordance with ISO9001:2008..

This declaration of conformity is valid until there is a significant change in the product and declared characteristics. ie. raw material or change in production process.

Signed by:

Name: *Simon Midwood*

Position: *Managing Director*

Date & Location: *12. 08. 2016*
TIMco House, CW5 6BJ

This declaration is the responsibility of the importer

T.I Midwood & Co. Ltd. Green Lane, Wardle, Nantwich, Cheshire, CW5 6BJ

